

Product Information Sheet



Railway Signaling

	Type RS6912 20V 10/10W BA20d
	Ordering – No. 46912
Product Description	Signaling Lamp
Features	Double Filament
Applications	Railway Signal

Technical Details

Type	RS6912
Rated Voltage (V)	20
Wattage (W) (at 20V) (MF/AF)	max. 10,7 / 10,7
Luminous Flux (lm) (at 20V) (MF/AF)	95 / 95 -10%
Lumen Maintenance (at 20V)	75% at 450h
Average Lifetime (h) (at 20V) (MF/AF)	600 / 50
Base	BA20d
Maximum Overall Length (mm)	67,0 - 5,0
Bulb Diameter (mm)	35,0 ± 1,0
Light Center Length (mm) (MF)	30,0 ± 0,25
Filament Distance (mm) (MF-AF)	2,2 + 0,8
Packaging Configuration	200 pcs.
Environmental Remark	Product don't contain lead or mercury and is conform with Directive 2011/65/EC "Restriction of the use of certain hazardous substances in electrical and electronic equipment".

Drawing (in mm)

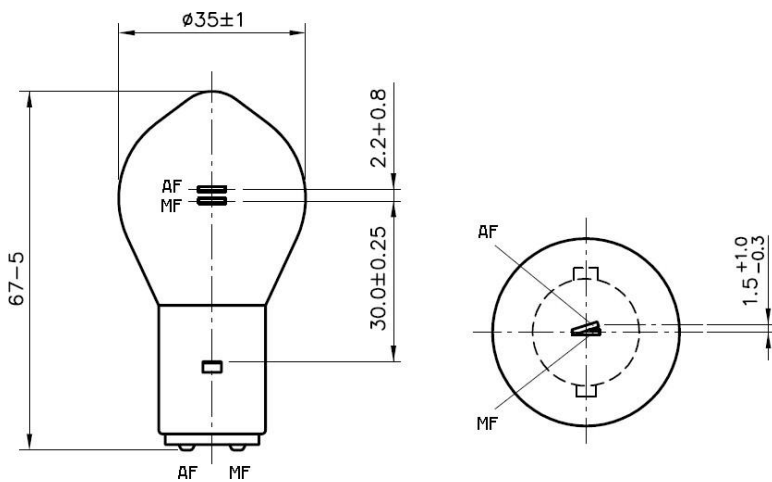

ITT 360
WIR MACHEN VERTRIEB

www.german-lamps.eu

www.ventas-focos-itt360.com

